

Residential Site Plan
Redrawn: Adam Killgo
Zoning: RM-1

159 Marlin Street
Athens, GA 30601

1,768 S.F. Heated
320 S.F. Front Porch

Building Height: 26'

Impervious Surfaces

Driveway: 1,900 Sq/Ft
House: 1,044 Sq/Ft

Lot: 6,900 Sq/Ft
Impervious: 30%

Scale: 1" = 20'

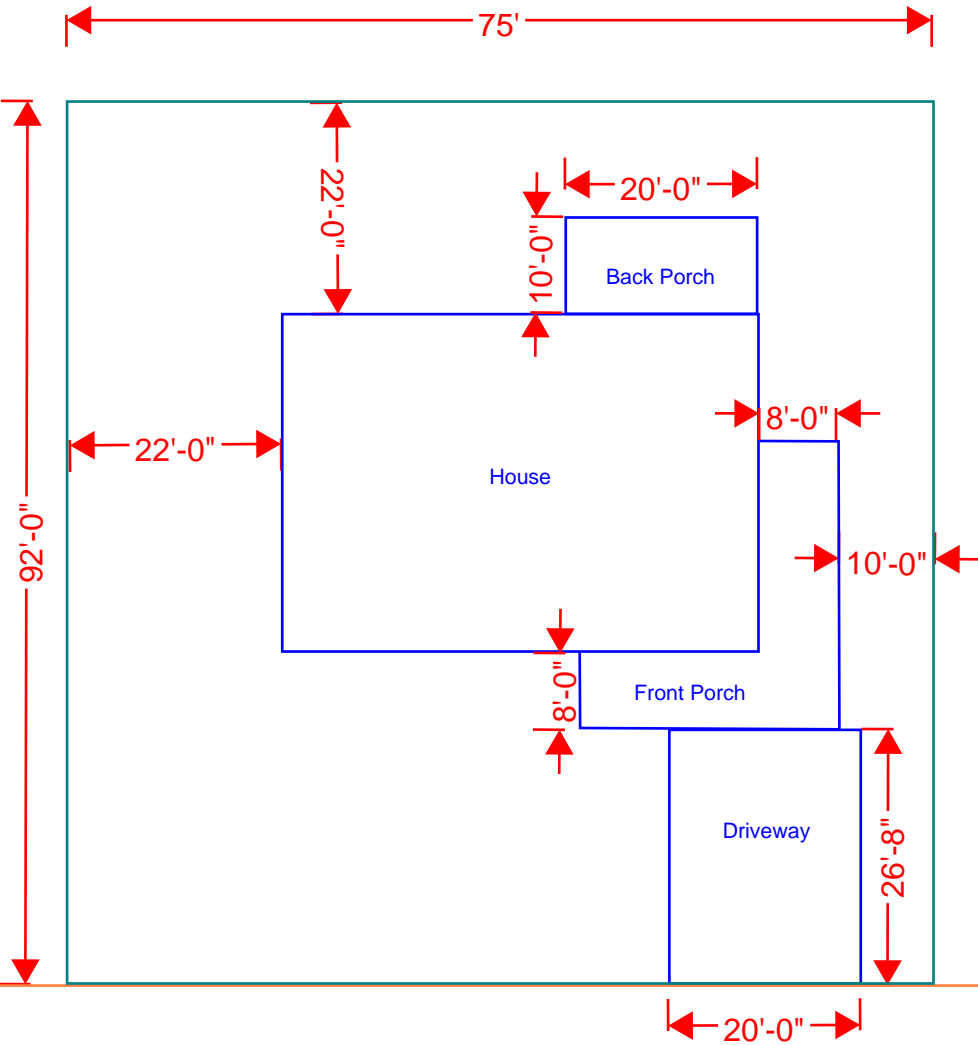
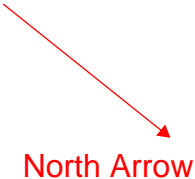

Marlin Street