

NOTE:  
NO MORE THAN 30 PERCENT OF ANY ONE SPECIES SHALL BE PLANTED ON A LOT

**PLANTING MATERIALS NOTE**

ALL TREE SIZES TO BE AS FOLLOWS:  
DECIDUOUS TREES - 2" CALIPER  
MULTI-TRUNK TREES - 1" CALIPER PER TRUNK  
EVERGREEN TREES - 8' IN HEIGHT

**LANDSCAPE CALCULATIONS**

ZONING: C-N

MINIMUM REQUIRED LANDSCAPE AREA: 25W

TOTAL LANDSCAPE AREA: 7,764 SF (38% OF NET SITE)

PARKING REQUIREMENTS: (1 TREE REQUIRED / 7 PARKING SPACES)

20 PARKING SPACES / 7 = 2.86 REQUIRED TREES  
3 PROPOSED

STREET TREE REQUIREMENTS: (1 TREE REQUIRED / 30 LF FRONTAGE)

NELLIE B. AVE.:  
227.6 LF / 30 = 7.59 TREES REQUIRED (8 PROPOSED)

VINE STREET:  
185.4 LF / 30 = 6.18 TREES REQUIRED (7 PROPOSED)

GREGGESS STREET:  
161.9 LF / 30 = 5.40 TREES REQUIRED (6 PROPOSED)

(1) CER CAN

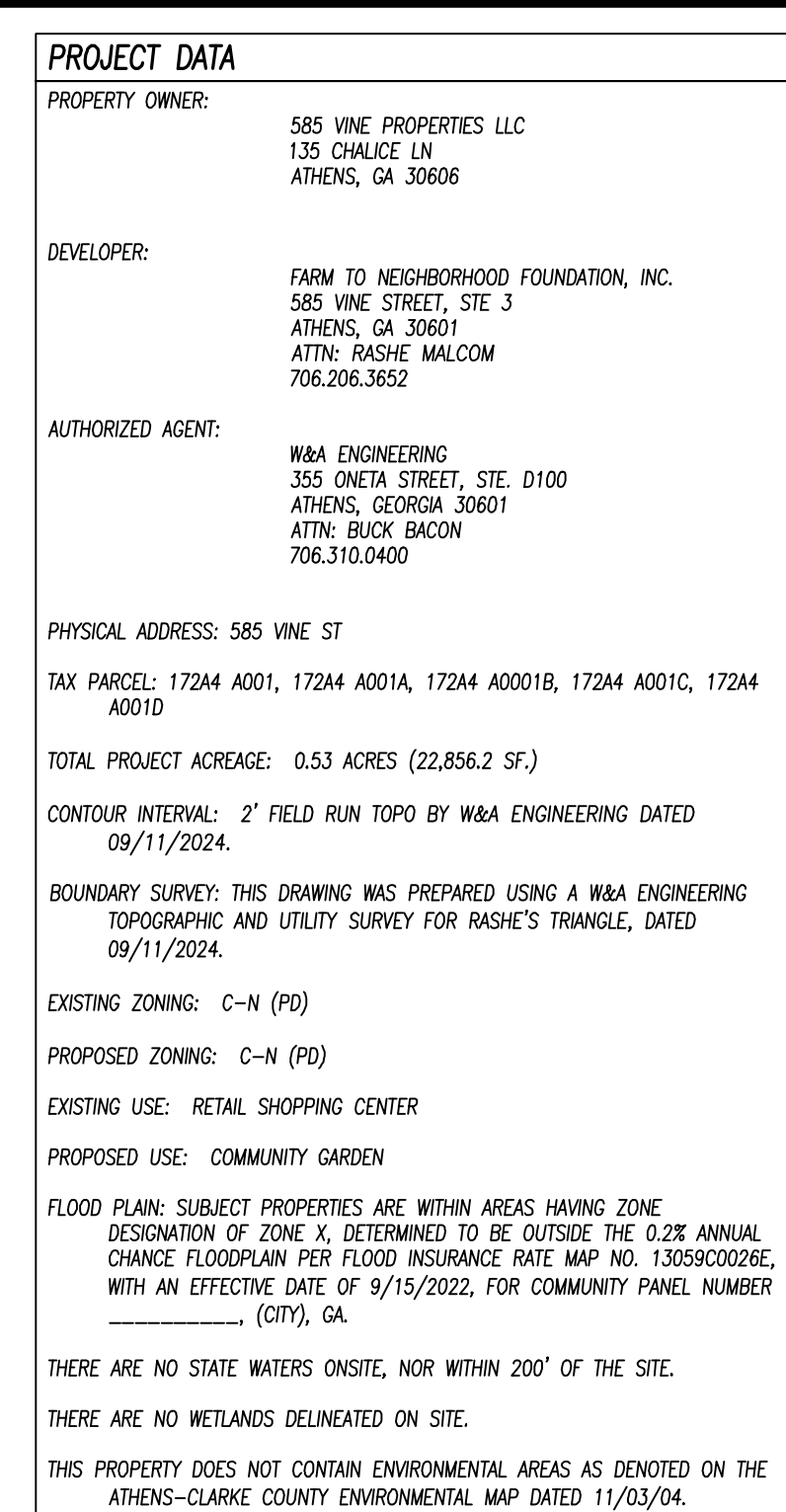

# **TREE MANAGEMENT PLAN NOTES**

1. ALL EXISTING UTILITIES ARE SHOWN AS LOCATED ON AN SURVEY FOR: POSTNET REAL ESTATE PARTNERS BY W&A ENGINEERING. LOCATIONS SHOULD BE VERIFIED BY CONTRACTOR AT TIME OF CONSTRUCTION.
2. USE TREE CANOPY CALCULATIONS FOR EXISTENCE ON SITE TREE GROUPS OR INDIVIDUAL TREES TO BE CONSERVED.
3. TREE REMOVALS SHALL BE IN ACCORDANCE WITH ALL ACC TREE ORDINANCES AS WELL AS ANY THAT MAY BE REQUIRED BY STATE & FEDERAL AGENCIES AT THIS TIME.
4. WITH A DBH GREATER THAN 2" ARE LOCATED IN THE R/W.
5. TREES PLANTED OR CONSERVED TO MEET CODE REQUIREMENTS SHALL NOT BE REMOVED WITHOUT PRIOR APPROVAL OF THE ACC ARBORIST OR FORESTER.
6. THE ACC ARBORIST OR FORESTER MUST INSPECT THE INSTALLATION OF TREE PROTECTION FENCING PRIOR TO COMMENCEMENT OF CONSTRUCTION ACTIVITY, INCLUDING DEMOLITION (WHEN PROPOSED), TREE PROTECTION FENCING SHALL BE INSTALLED IN PLACE UNTIL ALL CONSTRUCTION ACTIVITIES END. A CERTIFICATE OF OCCUPANCY IS ISSUED, WHOEVER IS LATER. CONTRACTOR TO COORDINATE INSPECTION.
7. TRUCKS OR OTHER EQUIPMENT, TRAFFIC, PARKING OR STORAGE OF MATERIALS IS ALLOWED WITHIN THE TREE PROTECTION AREA NOR WITHIN 10' OF THE TRUNK ANY CONSERVED TREE.
8. TREES PLANTED TO MEET DEVELOPMENT REQUIREMENTS SHOULD BE WATERED THROUGHOUT THE GROWING SEASON TO THE EQUIVALENT OF 1" OF WATER PER WEEK.
9. STAKING MATERIALS SHOULD BE REMOVED WITHIN ONE YEAR OF PLANTING. BURLAP (AND ALL OTHER MATERIALS) MUST BE REMOVED FROM AT LEAST THE TOP 10' OF THE TREE BALL. STAKES SHOULD BE PLANTED SO THAT TRUNK FIBRE IS VISIBLE ABOVE THE GROUND.
10. PLANTED TREES SHOULD BE MULCHED IMMEDIATELY AFTER PLANTING. MULCH SHOULD BE MAINTAINED TO A MINIMUM OF 2" DEPTH.
11. ALL PLANTINGS SHALL BE INSTALLED ACCORDING TO SECTION 8-9-19 OF THE ATHENS-CLARKE COUNTY CODE OF ORDINANCES.
12. ALL TREES PLANTED TO MEET DEVELOPMENT REQUIREMENTS FOR TREE PROTECTION FENCE(S) TO BE INSTALLED PRIOR TO ANY DEMOLITION ACTIVITIES.
13. FORESTED AREAS CONTRIBUTING TOWARDS CONSERVED TREE CANOPY AND CROWN COVER OR GREATER SHALL BE MAINTAINED TO THE MAXIMUM POSSIBLE CLEARING, CLEANING OF UNDERBRUSH IS NOT PERMITTED, EXCEPT FOR THE REMOVAL OF INVASIVE SPECIES.
14. THERE ARE NO KNOWN SPECIES OF TREES, BUT NOT ALL PROPOSED LANDSCAPING. SEE THE PLANT LIST ON THE LANDSCAPE PLAN FOR TOTAL REQUIRED ONSITE PLANTINGS, INCLUDING REQUIRED LANDSCAPE BUFFERS AND PLANTING.
15. THERE ARE EXISTING FORESTED AREAS ON THIS SITE, NO INDIVIDUAL TREES HAVE BEEN IDENTIFIED AND THEREFORE ARE NOT COUNTED AS SUCH IN THE CALCULATIONS.
16. THERE ARE NO AREAS ON SITE DESIGNATED FOR FOREST REGENERATION OR FUTURE FOREST(S).
17. ALL TREES GREATER THAN 2" DBH WHICH FALL OUTSIDE OF THE DESIGNATED AREAS SHALL BE CONSERVED. THE TREE DEVELOPMENT AREAS WILL BE FURTHER DEFINED BY CONSTRUCTION PLANS.

MINIMUM DISTANCES IN FEET REQUIRED BETWEEN TREES & STRUCTURES OR INFRASTRUCTURE BY TREE CANOPY SIZE CATEGORY				
STRUCTURE/ INFRASTRUCTURE DESCRIPTION	TREE CANOPY SIZE CATEGORY FROM THE ACC TREE SPECIES LIST			
	LARGE	MEDIUM	SMALL	VERY SMALL
STREET INTERSECTION, MEASURED FROM THE ROW BOUNDARY	35	35	35	35
TRAFFIC SIGNS	20	20	20	20
LIGHT POLES	30	20	15	15
OVERHEAD UTILITIES	30	20	0	0
UNDERGROUND UTILITIES	5	5	5	5
MALIBOXES	5	5	5	5
FH, ELECTRICAL BOXES, WM	5	5	5	5
CURB, SIDEWALK, EOP	3.5	3	2	2
BUILDINGS	15	10	5	5

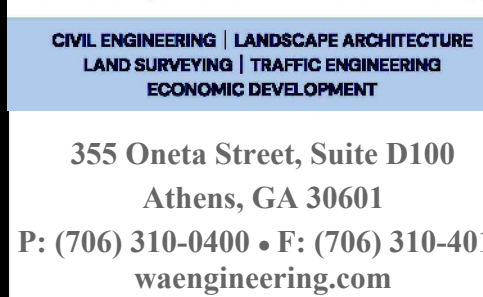
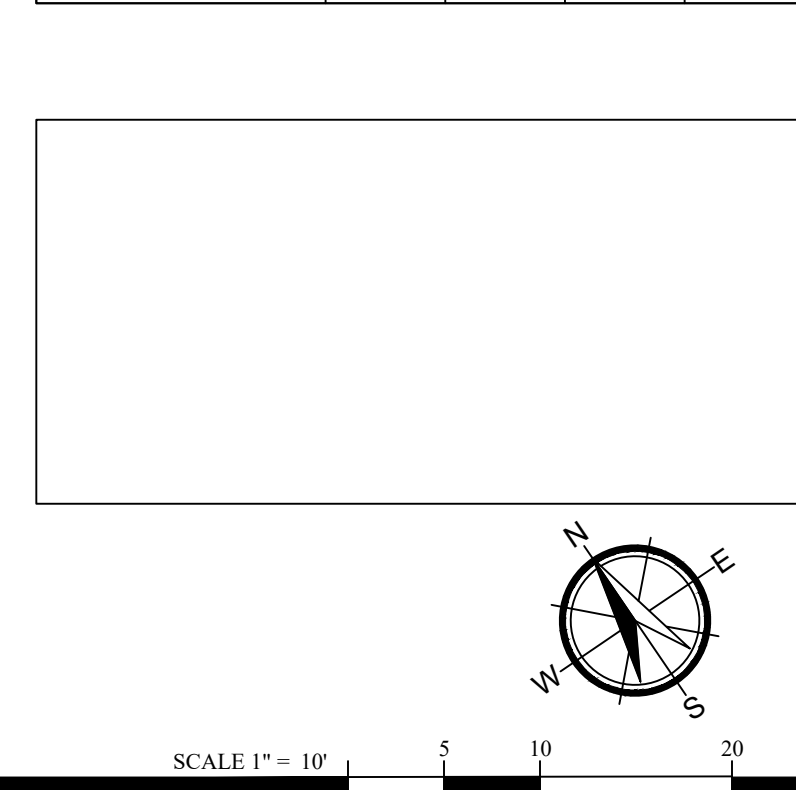

ALL DRAWINGS SHALL REMAIN THE PROPERTY OF W&A ENGINEERING. THESE INSTRUMENTS OF SERVICE ARE TO BE USED SOLELY FOR THE SPECIFIC PROJECT. W&A ENGINEERING SHALL RETAIN ALL LEGAL RIGHTS TO THE USE OF THE INSTRUMENTS OF SERVICE AND SHALL RETAIN FULL PROTECTION UNDER UNITED STATES COPYRIGHT LAW.

# EAST ATHENS WELLNESS EXPERIENCE

---

CLARKE COUNTY, GA  
585 VINE ST - 0.53 ACRES

Know what's below.  
Call before you dig.

## REVISIONS

[illegible]

FOR REVIEW ONLY

INITIAL SUB. DATE: 11/14/2022

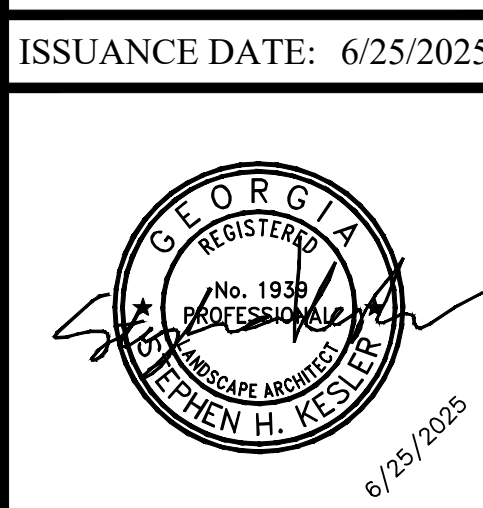

W&amp;A PROJECT #: 220064

## TREE MANAGEMENT PLAN

L201